

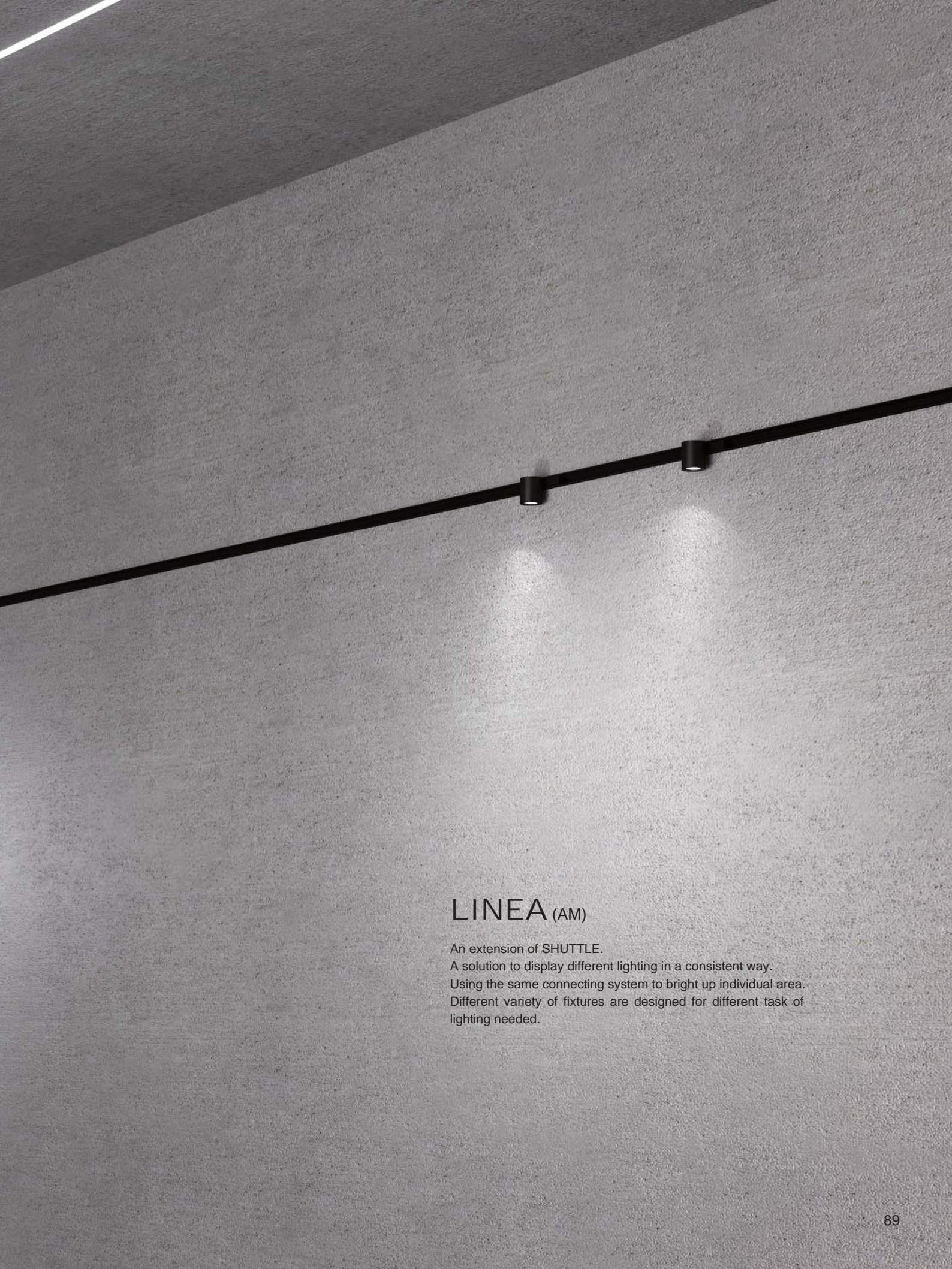

LINEA (AM) system



LINEA (AM)

An extension of SHUTTLE.

A solution to display different lighting in a consistent way.

Using the same connecting system to bright up individual area.

Different variety of fixtures are designed for different task of lighting needed.

LINEA TRACK

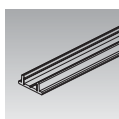

RW

Track

P.95

LINEA PROFILE

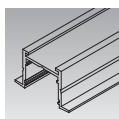

LIF

Trim recessed profile

P.95

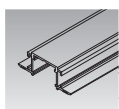





LIR

Trimless recessed profile

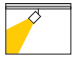
P.95

LINEA MODULES

	Series name	LED Consumption	Lumen	
 	LINEA-W	2.2W	210 (lm)	P.102
 	LINEA-B	4W	320 (lm)	P.103
 	SOFT	50W	10500 (lm)	P.104

LINEA (AM)



Drywall installation



Trim recessed type

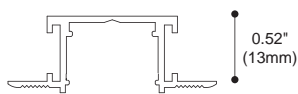

Trimless recessed type

Ultra slim profile can be cut into different length.
Can use directly with 5/8" drywall.
Cut the drywall in to the sizes needed for fast installation.

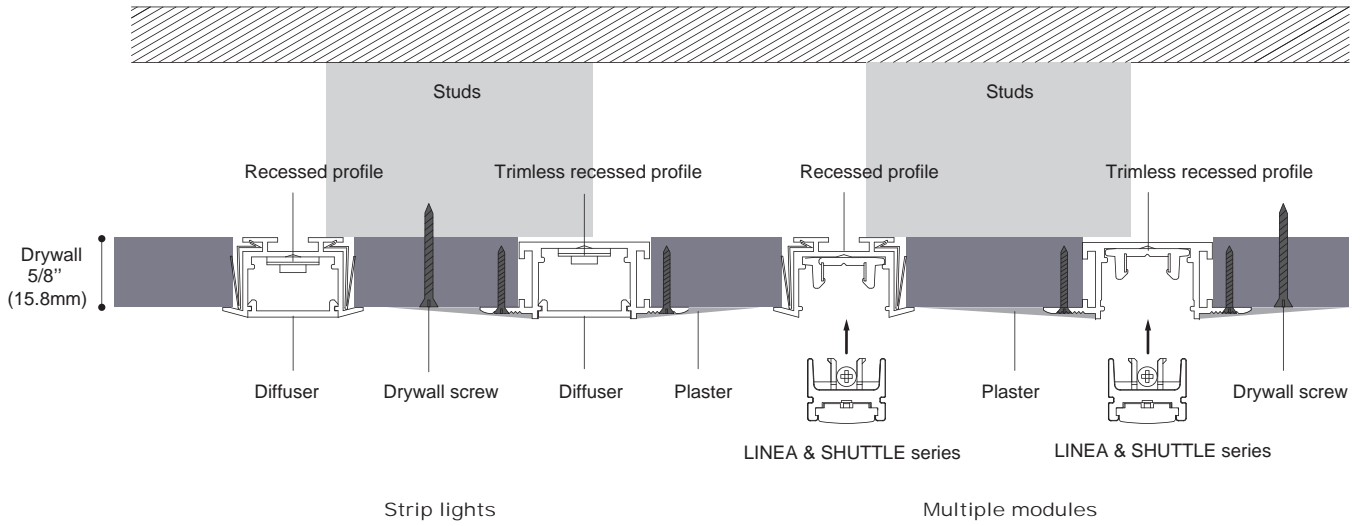

Strip lights

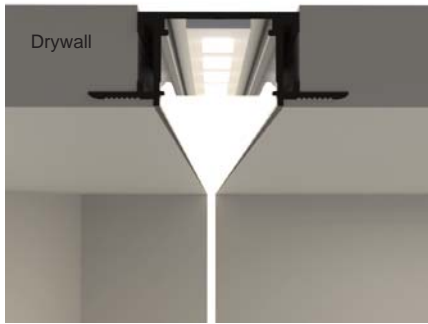

Secure the profile into the slot with screws.
 Connect strip lights with driver.
 Cut the strip light into needed length.
 Peel off the double sided tape and stick on the profile.
 Assemble the milky diffuser.

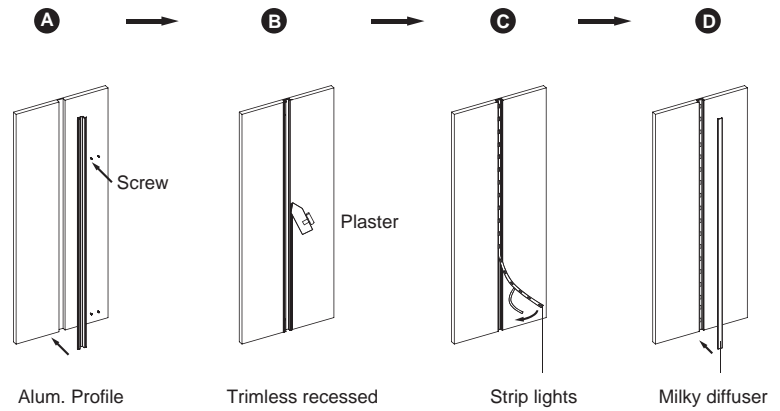

Multiple modules



Cut the profile & track into the length needed.
 Assemble the track into the profile.
 Connect the driver with power cord.
 Assemble the required modules on the track.

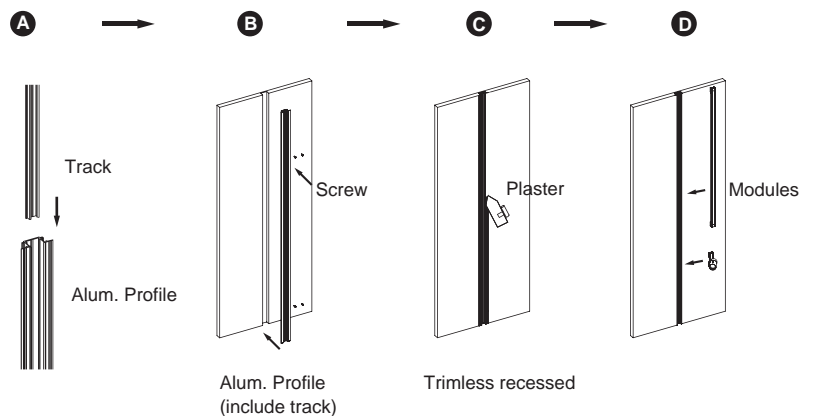

LINEA (AM)



Cut extrusion profile & track

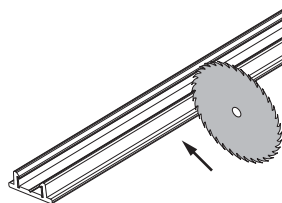
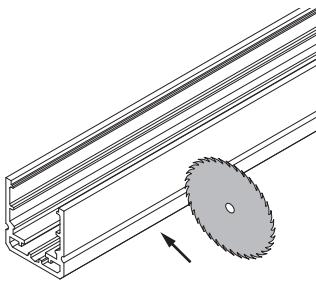

Linea is powered by 24V DC, 180W max driver.
A second driver is required if exceeds 180W
Safety is one of the advantage for low voltage
connecting system.
Elegant stylish fixtures are also designed for
multiple tasks with the system.

LINEA (AM)

Track

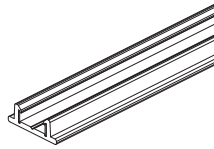

Track with adhesive tape

Article number	L
RW-610	39.37"(1000mm)
RW-620	78.74"(2000mm)
RW-630	118.11"(3000mm)

Profile

Colours Black

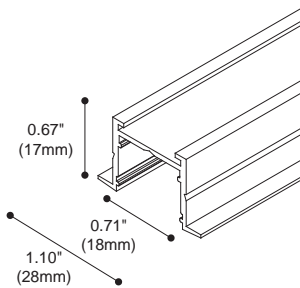

Trim recessed profile

Article number	L
LIF-01	39.37"(1000mm)
LIF-02	78.74"(2000mm)
LIF-03	118.11"(3000mm)

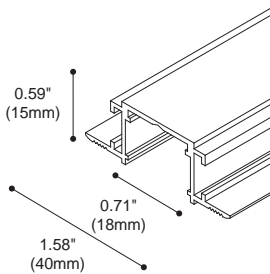

Trimless recessed profile

Article number	L
LIR-01	39.37"(1000mm)
LIR-02	78.74"(2000mm)
LIR-03	118.11"(3000mm)

Accessories

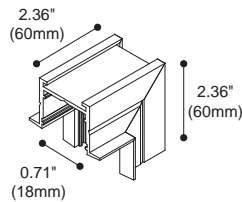

Article number : LIF-05
Type : Trim recessed vertical corner
L : 7.21" X 7.21"

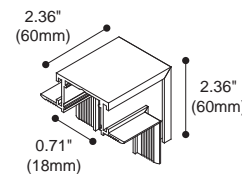

Article number : LIR-05
Type : Trimless recessed vertical corner
L : 7.21" X 7.21"

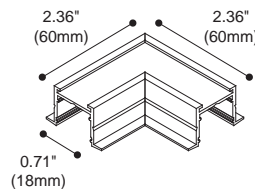
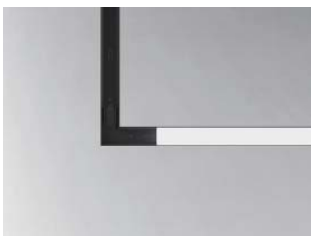

Article number : LIF-04
Type : Trim recessed horizontal Corner
L : 7.21" X 7.21"

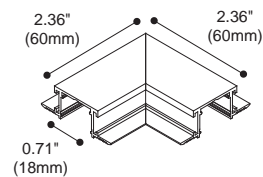

Article number : LIR-04
Type : Trimless recessed horizontal Corner
L : 7.21" X 7.21"

LINEA (AM)

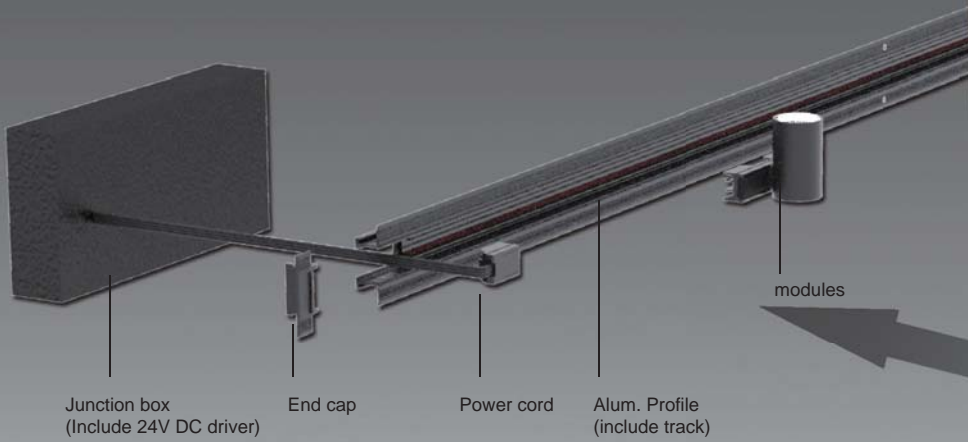

Multiple modules

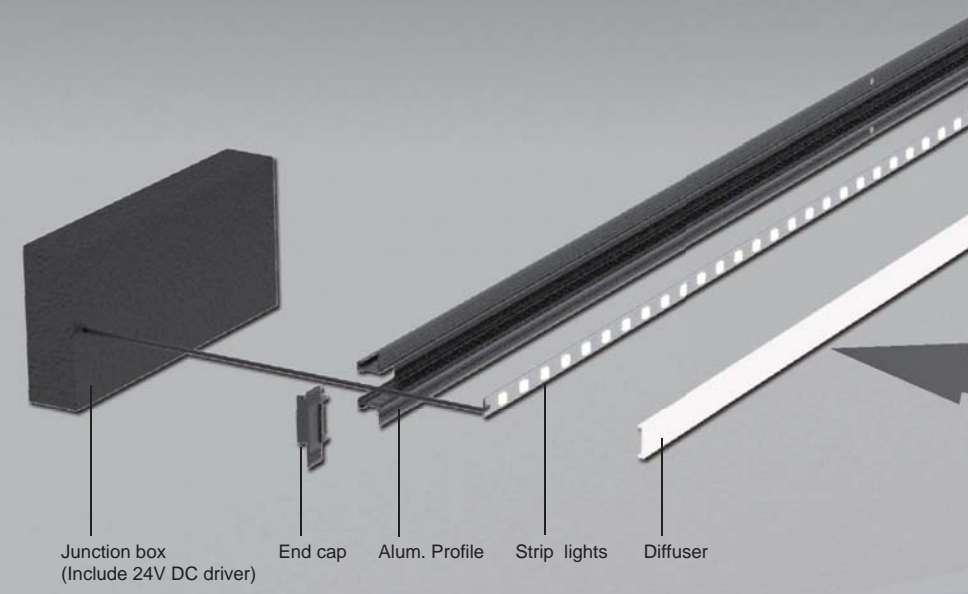

Strip lights

Junction box (Include 24V DC driver)

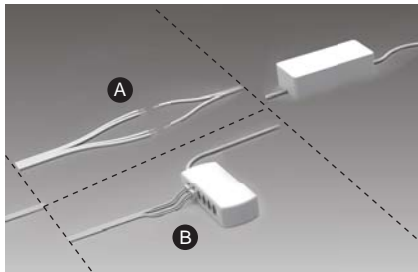

- A Without quick connector Max. 180W
- B With quick connector Max. 120W

Track Connection

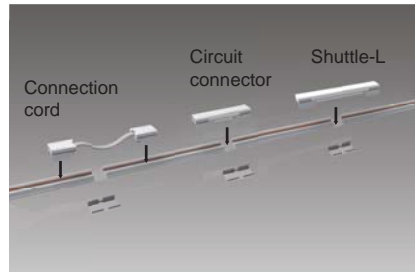

When multiple track is required, one of the three connection accessories can be used to continue the circuit.

Alum. Profile connection

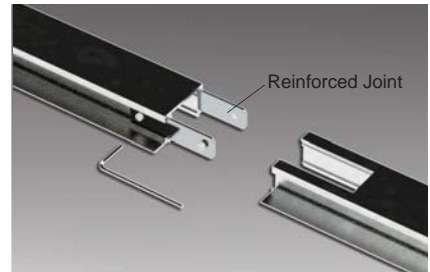

When multiple profile is required, use reinforced joint to connect profiles.

Accessories specifications

Power cord

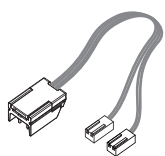

CP-MOL-27-200
Power Cord MOLEX Male Plug
Length : 78.74"(200Cm)

120W in one row

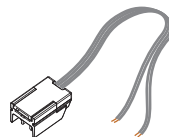

CP-27-200
Power Cord
Length: 78.74"(200Cm)

180W in one row

Connection cord

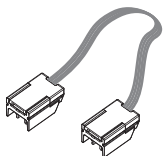

CS-27-15
Connection Cord Length: 5.91"(15cm)
CS-27-30
Connection Cord Length:11.81"(30cm)
CS-27-60
Connection Cord Length:23.62"(60cm)

120W in one row

Circuit connector



CSC-27
120W in one row

End cap

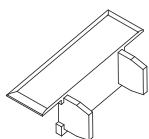

LIC-01
Trim End Cap

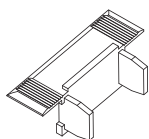

LIC-02
Trimless End Cap

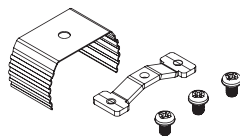

LII-01
Surface mounted clip

Cover

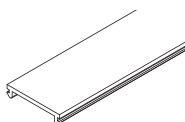

LIE-01
Cover (Milky / Black / Grey)
Length : 78.74"(200Cm)

Reinforced joint

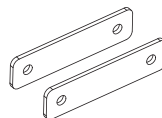

LIC-03
Reinforced Joint

Driver

	Article number	I/P Voltage/Hz (V/Hz)	O/P Voltage (VDC)	O/P Current (A)	O/P Power (W)	Dimension (Inch)	Junction box	Plug
	GME12A-240050FDS	100-240 / 50-60	24	0.5	12 max.	3.11"x1.50"x1.14"(H)	4pin	Yes
	GME36A-240150FDS	100-240 / 50-60	24	1.5	36 max.	3.82"x1.77"x1.14"(H)	4pin	Yes
	GME72C-240250FDR	100-240 / 50-60	24	2.5	60 max.	5.28"x2.00"x1.38"(H)	6pin	Yes
	AED15-700ILS	100-240 / 50-60	24	0.625	15 max.	4.41"x1.54"x 0.71"(H)	4pin	No
	AED36-1400ILS	100-240 / 50-60	24	1.25	30 max.	5.32"x1.85"x 1.03"(H)	4pin	No
	AED60-24VLS	100-240 / 50-60	24	2.5	60 max.	6.46"x1.89"x1.14"(H)	6pin	No
	HLG-150H-24	90-305 / 50-60	24	6.3	150 max.	8.98"x2.68"x1.54"(H)	No	No
	HLG-240H-24	90-305 / 50-60	24	10	240 max.	9.61"x2.68"x1.54"(H)	No	No



Linea connecting illustration

Connect the power cord to driver, click on the quick connector to supply power for Linea system.

24V DC 180W/120W max driver is required to power up the system, a second driver is needed if exceeds 180W/120W.

Suggest to use 80% of the driver output, e.g., 120W connects 96W modules.

Each driver to power up each loop, DO NOT interconnect the loops.

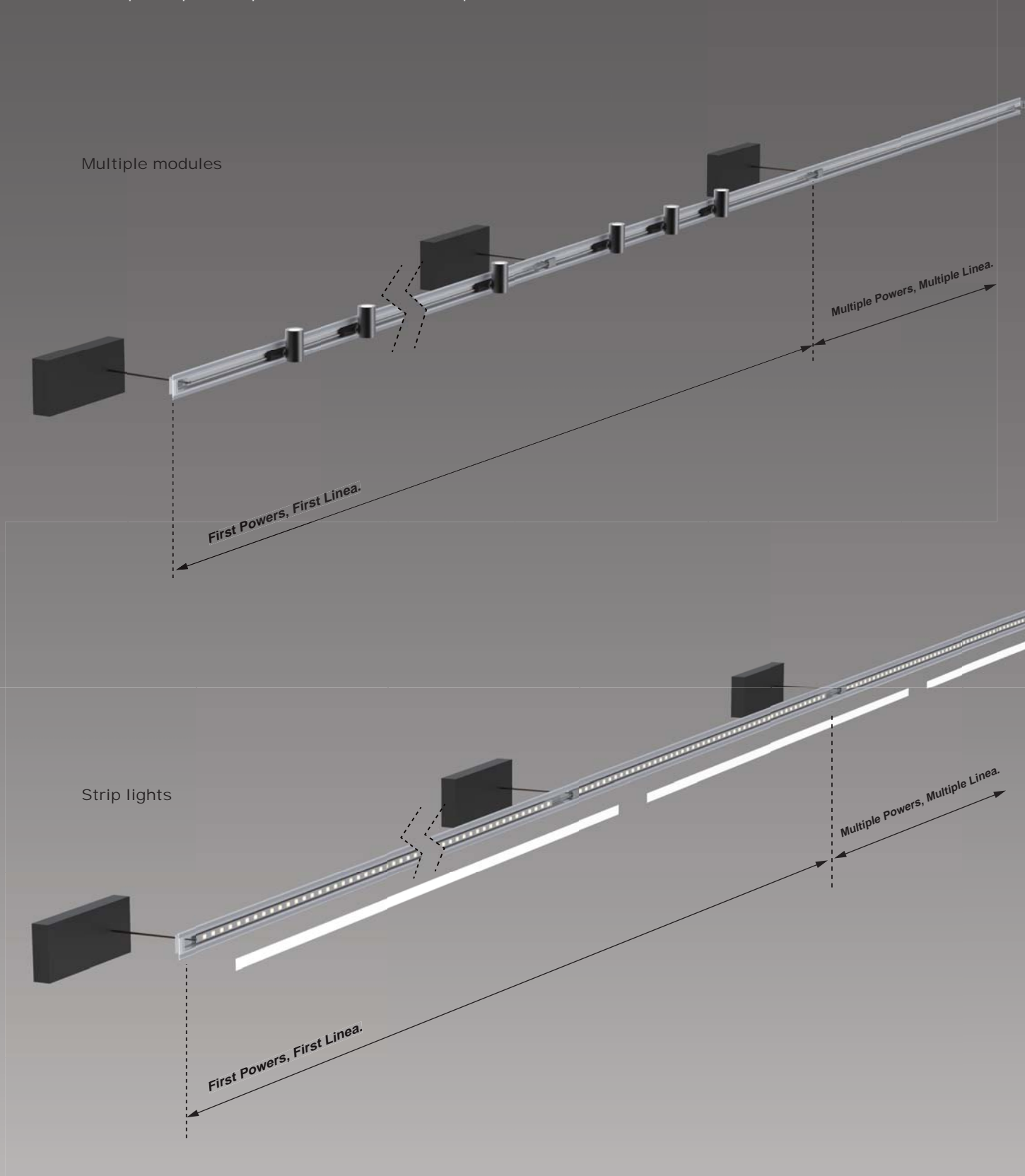

LINEA multiple module & Strip connection

Connect the power cord to driver, click on the quick connector to supply power for Linea system.
Must connect the Linea module first then the strip lights.

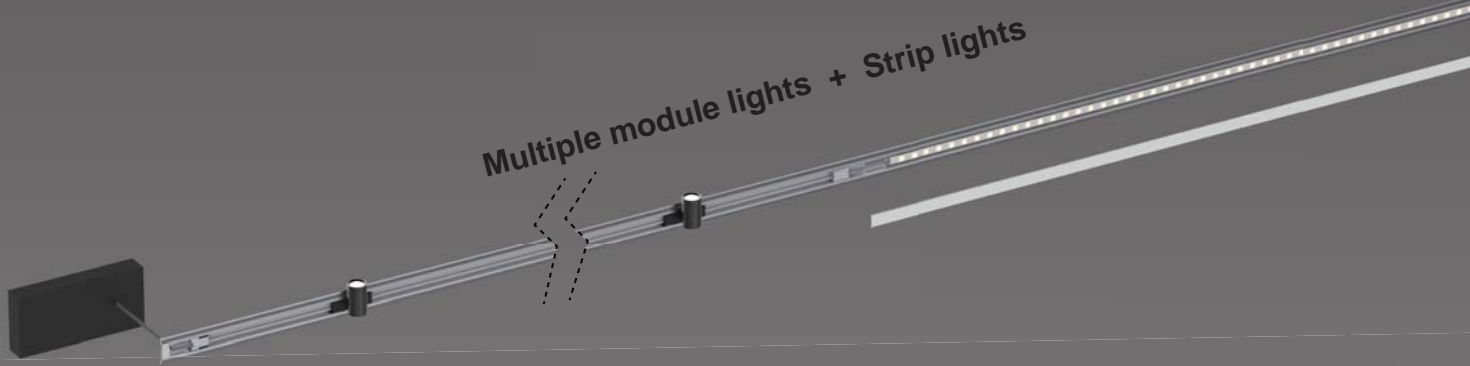

New driver is needed when strip lights are connected first, this is to prevent voltage drop.

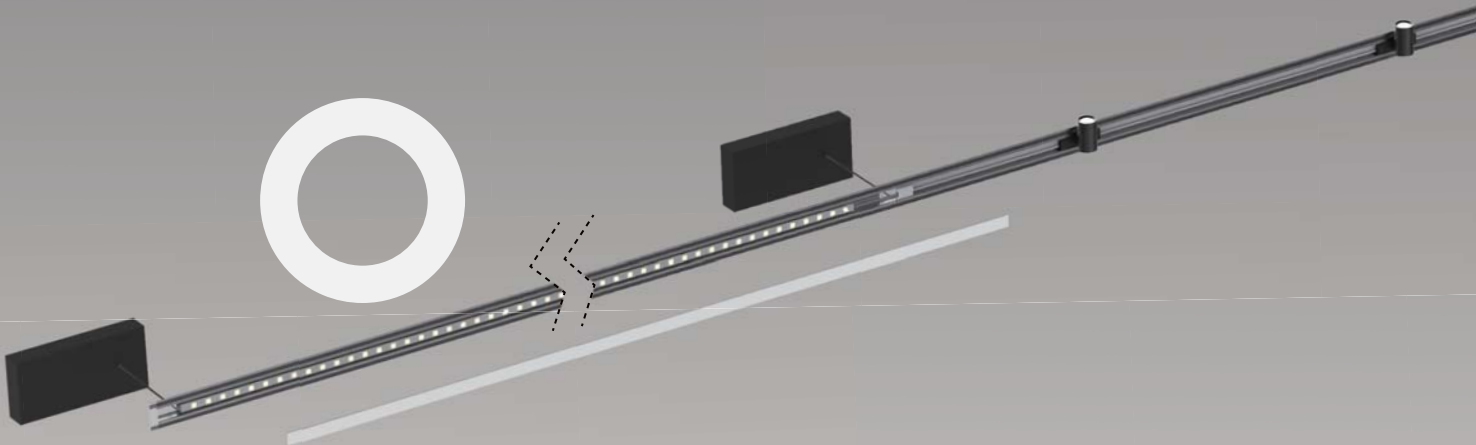
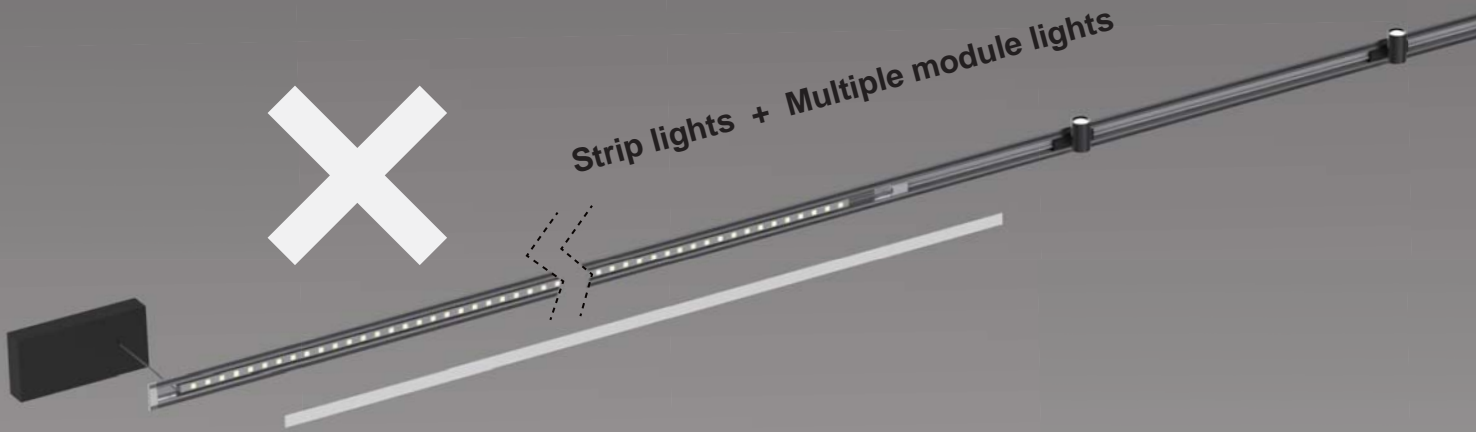

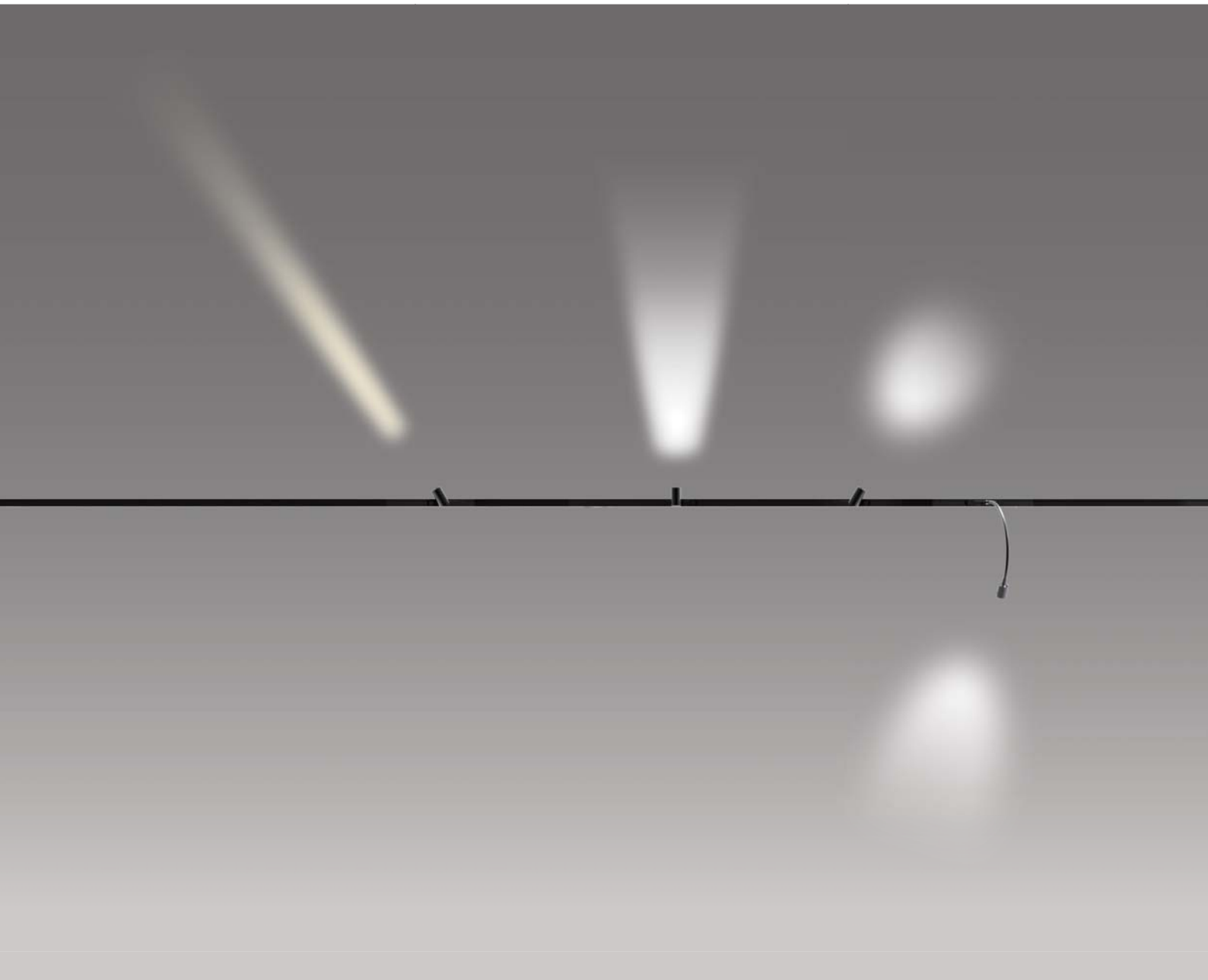

LINEA (AM)

Multiple Linea modules to provide complete multitasking lighting needs.
Select the required Linea module required, just plug and play to light up the space.



LINEA-W
Wallwash module.



SHUTTLE-S
Available in 1W & 2.2W from SHUTTLE series.
Beam angle changeable by adjusting the lever.

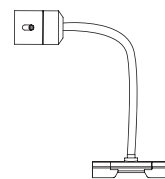

SHUTTLE-N
Spot module from SHUTTLE series.
Bendable tube provides more precision spot location.
Changing beam angle by adjusting the lever.



LINEA-B
Ball shape module.



SHUTTLE-B
Round shape module
from SHUTTLE series.



SHUTTLE-L
Linear module from
SHUTTLE series.



SHUTTLE-L-S
Linear module with
square diffuser from
SHUTTLE series.



SOFT
Strip light application.

LINEA-W

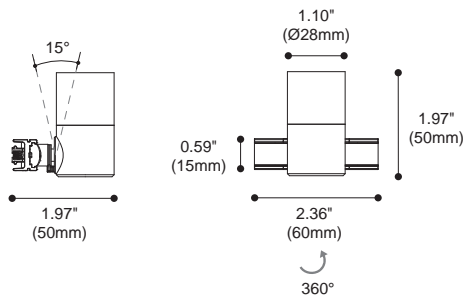

1719.215

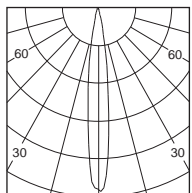

h (m)	D (m)	E (lx)
16°		
0.5	0.11	9874
1.0	0.22	2468
1.5	0.34	1097
2.0	0.45	617
2.5	0.57	395

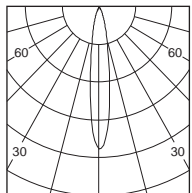

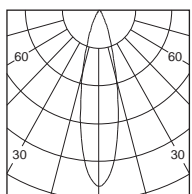

h (m)	D (m)	E (lx)
22°		
0.5	0.13	4310
1.0	0.27	1078
1.5	0.41	478
2.0	0.55	269
2.5	0.69	172



h (m)	D (m)	E (lx)
36°		
0.5	0.21	2488
1.0	0.43	622
1.5	0.65	276
2.0	0.87	155
2.5	1.09	99



Colours  Black  Anodized Alum.



Product performance

Article Number	LED Consumption	Voltage	System Lumen	Beam Angle	LED Type	LED q'ty	CCT/CRI
1719.215	2.2W	24VDC	210 (lm)	16°/ 22°/ 36°/ 29°x57°	High Power	1	30/80+

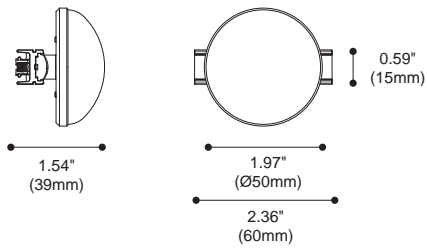

LINEA-B



Colours  Black  Anodized Alum.

Product performance

Article Number	LED Consumption	Voltage	System Lumen	Beam Angle	LED Type	LED q'ty	CCT/CRI
1768.101	4W	24VDC	320 (lm)	125°	SMD	18	30/80+



SOFT

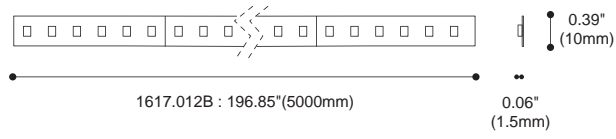

Product performance

Article Number	LED Consumption	Voltage	Lumen	Beam Angle	LED Type	LED q'ty	CCT/CRI
1617.012B	50W	24VDC	10500 (lm)	120°	SMD	600	30/80+



